

Ayvalık Profitis Ilias Church and Bell Tower

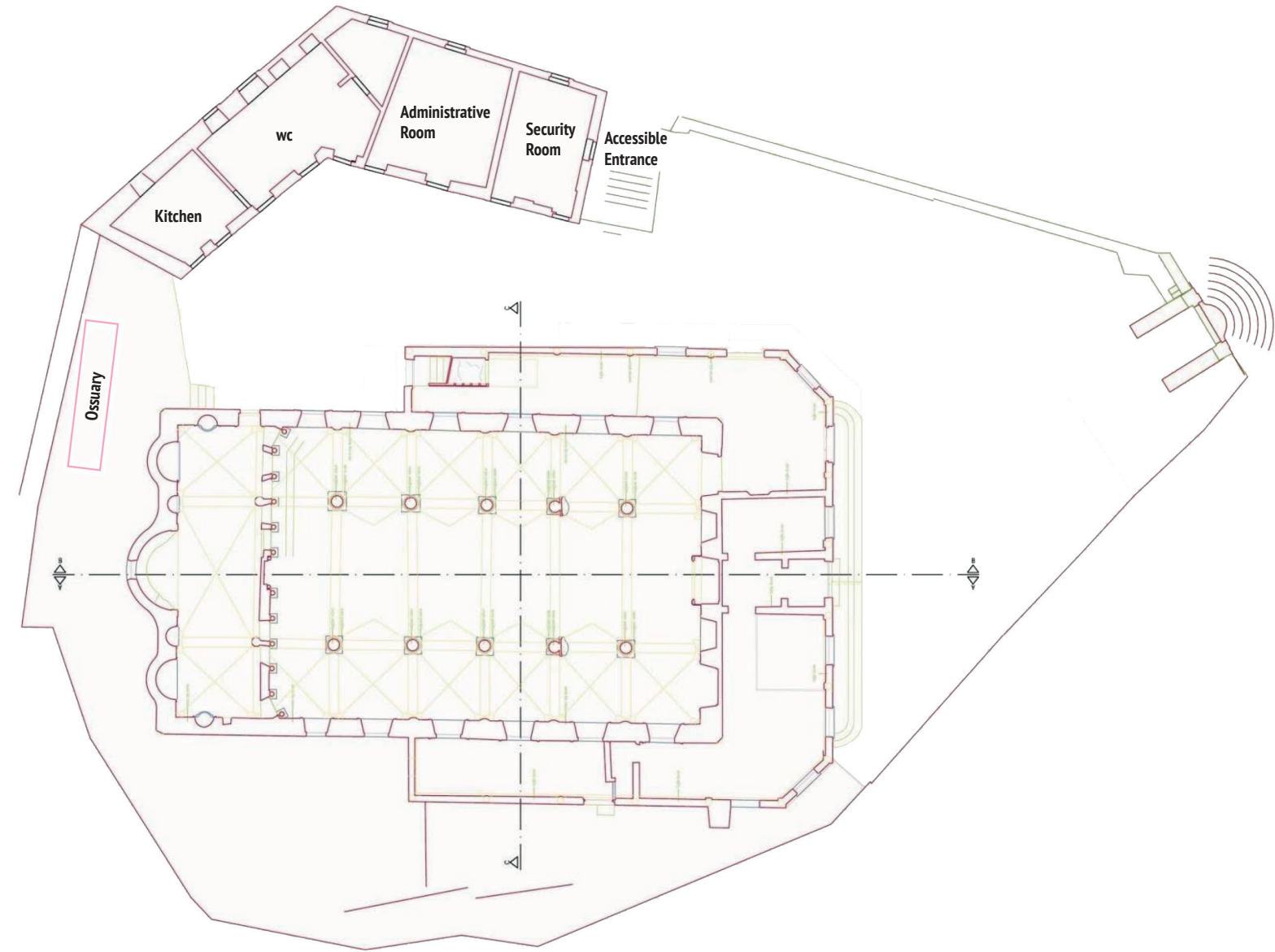

Church of Taxiarches general plan (by Sabriye Semra Emek)



Visiting Hours

April 1 - October -1

Opening Time: 10:00  
Closing Time: 17:00  
Ticket Office Closing Time: 16:00

October 1 - April 1

Opening Time: 08:30  
Closing Time: 17:30  
Ticket Office Closing Time: 17:00

Closed on Mondays, Saturdays, and Sundays.

Address: İsmetpaşa Mahallesi, Arası, Mareşal Fevzi Çakmak Cd. 11. Sk., 10400 • Phone: 0266 243 31 81

Please visit the web site for up-to-date information.

[f TurkishMuseums](#) [i officialturkishmuseums](#) [t TurkishMuseums](#) [y TurkishMuseums](#) [e TurkishMuseums](#)

[www.turkishmuseums.com](http://www.turkishmuseums.com)



[www.muze.gov.tr](http://www.muze.gov.tr)

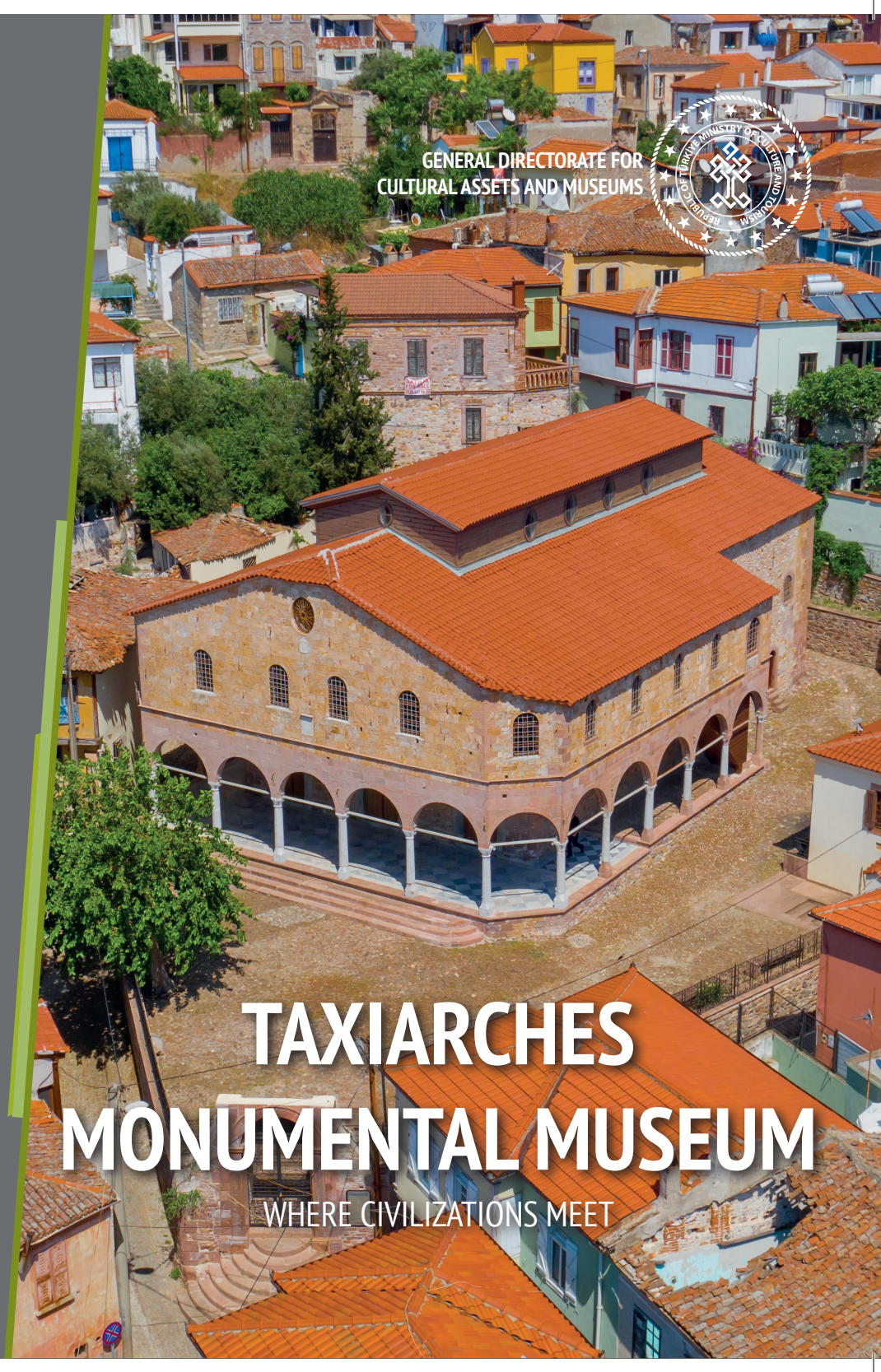

GENERAL DIRECTORATE FOR CULTURAL ASSETS AND MUSEUMS



# TAXIARCHES MONUMENTAL MUSEUM

WHERE CIVILIZATIONS MEET





Taxiarques Church is the first church of Ayvalik and it is believed to date back to 3 different periods. The building, which was originally built as a small church in the 15th century, is located at the southern garden entrance with the fresco of the representation of the god. The inscription on it dated 1753 provides information about the building from the second period with a three-domed, two-story basilica plan.

From the inscription above the entrance, dated 1844, it appears that the 3rd period basilica was built with a barrel vault and the upper carriers were entirely of wood. Access to the three-nave church is through three main doors in the narthex on the west façade of the building. In the central nave of the church is the pulpit, decorated with plaster reliefs depicting lion figures, and the iconostasis is accessed by a spiral staircase. The cathedral, located on the cross, is decorated with marble reliefs and gold leaf.



Just after passing near the iconostasis, which is furnished with marble icons narrating the life of Jesus Christ, and which is adorned with marble reliefs and gold inlays, we reach the apse in the rear. On the second floor of the building there is a Gynaecium with 16 windows, round arches, wooden, "U" shaped upper gallery, built as a women's section. This section is accessed by stone stairs with bell towers to the north and wooden stairs to the south. Marble imitation mural ornaments inside the structure, secco (pencil work on dry plaster) painting by applying lime plaster on wooden bagdadi. From the wall decorations and paintings, it can be seen that the decorations were changed during the restoration works of the building, which was damaged by the earthquake in different periods.



During these renovations, the fresco in the dome was replaced by the Icon of Pantocrator Jesus and the paintings of the apostles around the barrel vault were replaced by neoclassical oil paintings. The interior decoration of the church in 1893 was eclectically completed in the neoclassical style.

The structure, which was used as a tobacco and alcohol warehouse for a long time since 1927, was restored by the Ministry of Culture and Tourism in 2012 and put into service as "Taxiarques Monumental Museum" as a single unit under the Balıkesir National Forces Museum Directorate in 2013.