

MUSEUM PLAN

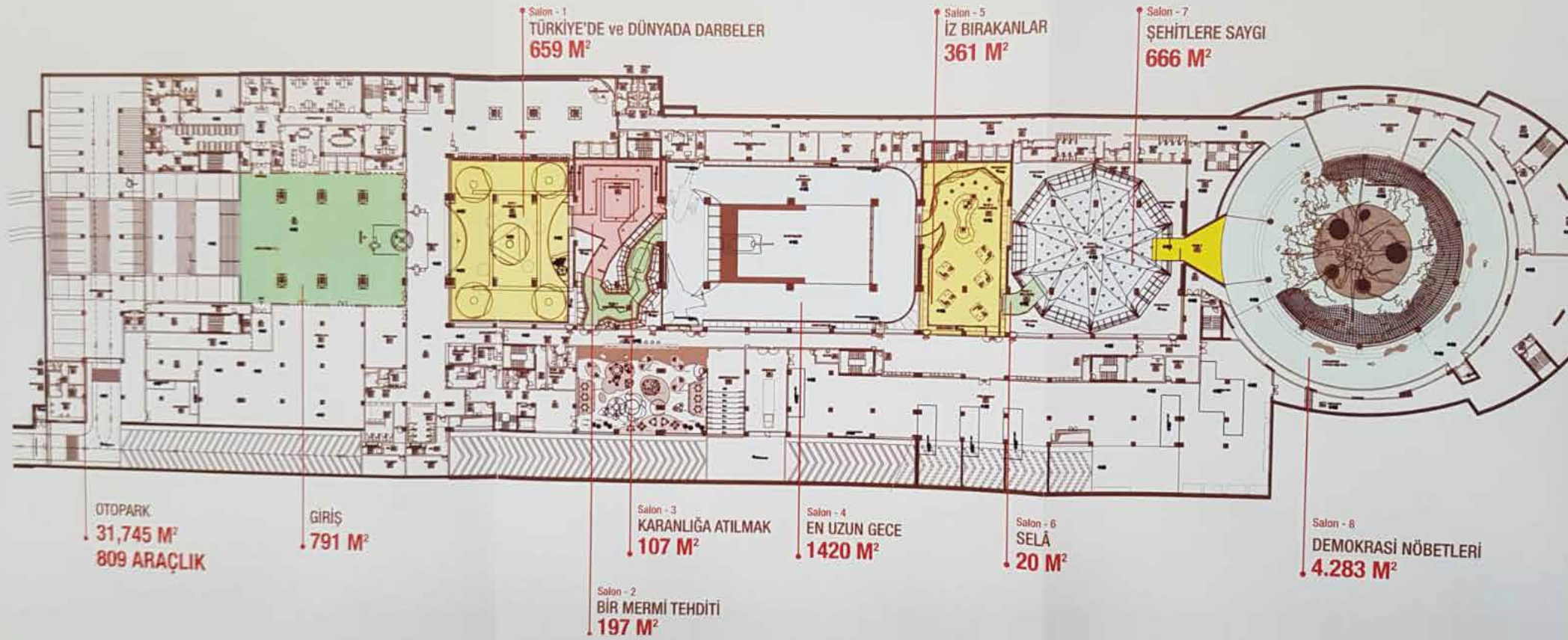

Visiting Hours

Opening Time: 09.00
Closing Time: 17.00
Ticket Office Closing Time: 16.30

Closed on Mondays.

Address: Emniyet Mah. Alpaslan Türkeş Cad. No: 18 Yenimahalle/ANKARA • **Phone:** 0 312 543 40 06
Mail: 15temmuzdemokrasimuzesi@ktb.gov.tr

Please visit the web site for up-to-date information.

[f TurkishMuseums](#) [officialturkishmuseums](#) [TurkishMuseums](#) [TurkishMuseums](#) [TurkishMuseums](#)

www.turkishmuseums.com



www.muze.gov.tr



GENERAL DIRECTORATE FOR
CULTURAL ASSETS AND MUSEUMS



15 JULY DEMOCRACY MUSEUM

Museum Open Exhibition Area Valley 'Turkish Flag Engraved on Marble'



Museum Open Exhibition Area Walley 'Reliefs'



Hall 1 "Coups In Turkiye and The World"



Hall 2 "The Threat of A Bullet"



Hall 3 "Plunge Into Darkness"



Hall 4 "The Longest Night"



Hall 5 "Those Who Left a Mark"



Hall 7 "Honouring Martyrs"



Hall 8 "Democracy Guard"



Hall 8 "Democracy Guard"



The 15 July 2016 coup attempt was disposed by the resistance of the Turkish nation. In this coup attempt, which was a treacherous attempt targeting state institutions and the nation, 251 of our citizens became martyrs and 2733 of our citizens were injured and became veterans.

It is of great importance to ensure that the events of that dark night, the heroism displayed by the Turkish nation and its commitment to freedom and democracy are not forgotten by future generations. In addition, the museum also informs visitors about the illegitimate and insidious activities of the parallel structure, which is the perpetrator of the 15 July coup attempt, in order to understand the 15 July coup attempt correctly.

In the museum, there are eight different exhibition halls with the themes of 'Coups in Turkiye and the World', 'The Threat of A Bullet', 'Plunge into Darkness', 'The Longest Night', 'Those Who Left A Mark', 'Sala', 'Honouring Martyrs' and 'Democracy Guard'.

In the halls; what happened on the day and night of 15 July, the resistance of the Turkish nation against the traitors with its belief in democracy and how bright Turkiye was reached are explained by supporting digital technologies.

In the 65640 m2 museum, in addition to the themed halls, there are temporary exhibition areas, children's section, car park for 809 vehicles, administrative units and service areas.

In the area of 92820 m2, which is completely allocated to landscape with its structural and vegetative arrangements, the museum was built underground, except for the ellipse shaped dome of 57x75 metres covering the 4283 m² 'Democracy Guard' themed hall, which symbolises the unification of the Turkish Nation as a single body.

Visitors can reach the 15 July Martyrs' Memorial by proceeding through the Valley designed as an open exhibition area at the exit of the museum.